

PRAIRIE SONG METROPOLITAN DISTRICT Nos. 3-6, 8 & 9
c/o Pinnacle Consulting Group, Inc.
550 W. Eisenhower Blvd. | Loveland, CO 80537
Phone: 970-669-3611 FAX: 970-669-3612
Email: psmdadmin@pcgi.com

December 21, 2022

Weld County
Office of the Clerk and Recorder
1250 H St.
Greeley, CO 80631

Via Email: ckoppes@weldgov.com

Weld County
Office of the Assessor
1400 N. 17th Avenue
Greeley, CO 80631

Via Email: BDones@weldgov.com
cc: fassessor@weldgov.com

Division of Local Government
1313 Sherman Street, Room 521
Denver, CO 80203

Via E-Filing Portal
Prairie Song Metropolitan District Nos. 3-6 8&9
(# 66519, 66520, 66521, 66522, 67615, 67616)

Dear Sir or Ma'am:

As required by statute (C.R.S. 32-1-306) and 32-1-104 (3)(b), all Title 32 Article 1 Special Districts are required to annually file a current, accurate map of district boundaries with the County Clerk and Recorder, Assessor and Division of Local Government.

On behalf of Prairie Song Metropolitan District Nos. 3-6, 8&9 please accept the district boundary map. The District is located within Weld County. Please feel free to contact me with any questions or concerns.

Sincerely,

PRAIRIE SONG METROPOLITAN DISTRICT NOS. 3-6, 8 & 9

Kevin Mitts
Assistant District Manager

EXHIBIT

LEGEND

- ◆ ALIQUOT CORNER (AS DESCRIBED)
- METRO DISTRICT
- - - PLSS ALIQUOT LINE
- ALL LINEAL UNITS ARE US SURVEY FEET

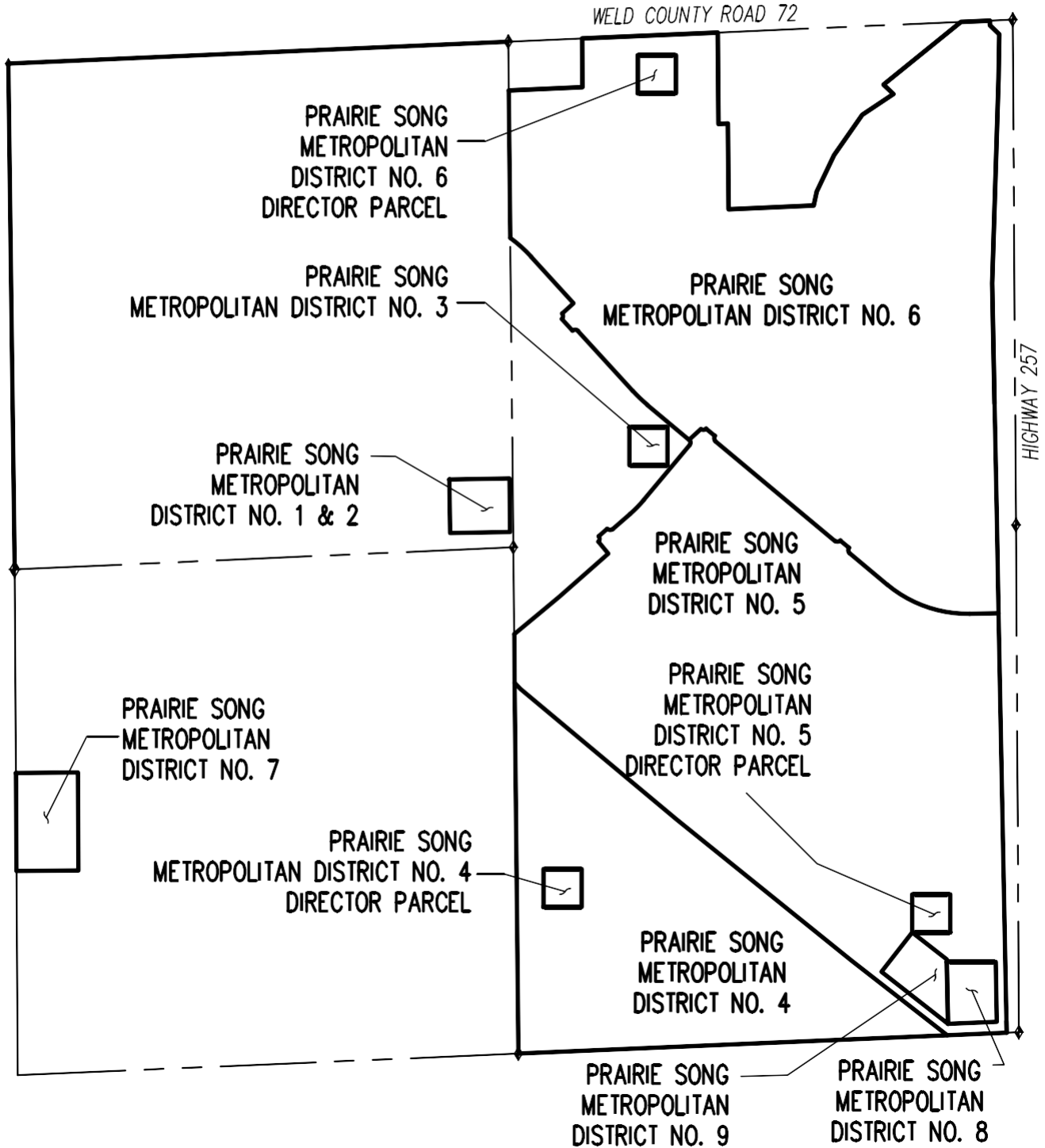
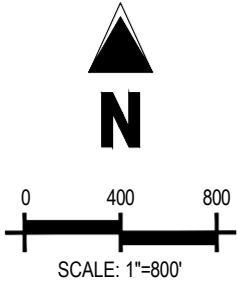

Project No:	HFH000021.10
Drawn By:	AN
Checked By:	RCR
Date:	10/11/2021 REV. 12-08-2021



5265 Ronald Reagan Blvd., Suite 210
 Johnstown, CO 80534
 970.800.3300 • GallowayUS.com